

When you need reliable accessories to complete your fishing kit think 'Alvey'. All our products are factory checked and manufactured using the latest injection moulding techniques. Our accessories are all UV stabilised and will resist harsh sunlight so that you get maximum use from your Alvey purchase. No matter what your requirement there is an Alvey fishing accessory to suit your application.

fish measure stick



Size 38cm and 80cm available. Legal sizes of most common varieties for each state are shown on the back of the ruler.

fish scaler



Strong plastic scaler that won't rust or cut your hands like a metal scaler.

rod buckets



Heavy duty leather or moulded rubber, plain or with gimbal bar for boat rods. Worn around your waist these buckets support the butt of the rod and make fishing a lot more comfortable.

hook disgorger



A slender plastic implement that every angler should have to remove the hooks that some fish always manage to swallow.

line casting plugs

7grms weight, ideal for learning to cast with safety in mind.



surf kit

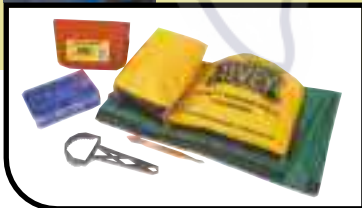

A comprehensive Alvey accessory kit for your surf fishing requirements.

junior & senior tackle boxes



Versatile bakelite tackle boxes, ideal for beach, hiking or bushwalking.

hand casters



HC10 holds 700m of 38kg line.



6 sizes available from 10cm to 25cm.

tackle boxes (clear lid)

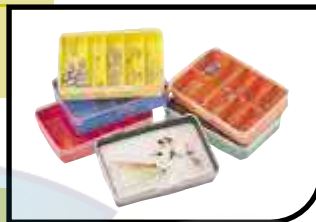

Variety of designs. Stackable with clear lids that allow you to see your tackle. (5 compartment layouts available.)
Tackle not included.

reel lube



Top quality anti-corrosive and water resistant grease for all your reels.

new alvey line



Fine diameter line made in Australia to suit sidecast reels.

The following points must be noted when purchasing a rod to suit your reel:

- Low winch fitting (About 15 to 20cm from the end of rod)
- To avoid restricting the line coils when casting, your first runner must be half way up the rod.
- An open runner centres line and takes tension off your finger when winding in. See Page 9.



To ensure you purchase the correct rod for your Alvey reel, consider a purpose built Alvey rod. These imported rods have been designed by Alvey and will guarantee best performance from your reel.

Rod (*Open Runner)	Purpose	Material	Length	Line Class
Rod 400	Junior/Beginner	Solid glass-2 Piece	1.5m (5')	3kg
* Rod 450	Freshwater/Estuary	Hollow glass-2 Piece	1.8m (6')	3kg
* Rod 500	General Purpose	Hollow glass-2 Piece	2.1m (7')	3kg
* Rod 600	Estuary/Light Surf	Hollow glass-2 Piece	3.2m (10'6")	5kg
* Light Surf Custom	Estuary/Light Surf	Superior Hollow glass Hi Quality fittings-2 Piece	3.6m (12')	5kg
* Rod 650	Surf	Hollow glass-2 Piece	3.9m (13')	7kg
* Surf Champion Custom	Surf	Superior Hollow Glass Hi Quality fittings-2 Piece	3.6m (12')	7kg
Rod 925	Boat	Solid Glass-1 Piece	1.8m (6')	24kg

**Rods pictured
top to bottom:**

Rod 450
Surf Champion Custom
Rod 650

When servicing your Alvey reel use the following picture as a guide to grease and lubrication points.

(Note: All graphite Alvey reels with drag do not require oiling of the drag washers)

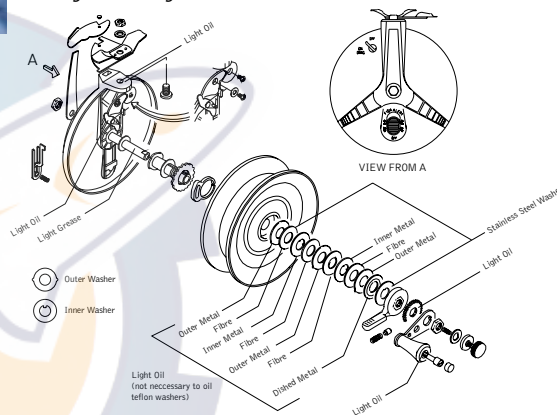

spare parts

Alvey Products are of the highest quality and will give you many years of trouble free service. However, should you require parts they are available through your local tackle shop. Many Parts are interchangeable between models.





jacket

Super, light weight, lined spray jackets with zipper. Very warm, yet comfortable to wear (logo front and back).



beanie



long sleeve polo
(khaki or navy)



short sleeve polo

These very smart short sleeved collared shirts are extremely versatile and can be worn to casual functions or when fishing (Blue with white shirt, logo front and back)



caps (suede or cotton)

Available in a range of colours and styles, these great new embroidered caps really look the part!



**bottle opener, patch, stubbie cooler,
keyring, better fisherman booklet**

56 page full colour booklet on 'How to become a better fisherman'.

order form

product	size	quantity	price inc. GST	total				
Alvey Cap - cotton	One size fits all		\$ 8.80	\$				
Alvey Cap - suede & brushed cotton	One size fits all		\$ 16.50	\$				
Alvey Beanie	One size fits all		\$ 9.90	\$				
	(cm)	95	100	105	110	115		
Alvey Short Sleeve Polo (Aust. Made)							\$ 28.00	\$
Alvey Long Sleeve Polo (Aust. Made)							\$ 38.00	\$
Alvey Spray Jacket (Aust. Made)							\$ 69.00	\$
Alvey Shark stubble opener (Aust. Made)							\$ 3.50	\$
Alvey patch (Aust. Made)	Superior				80 Years		\$ 5.50	\$
Alvey stubble cooler							\$ 6.00	\$
Alvey Reel 3D Pewter Key Ring (Aust. Made)							\$ 11.00	\$
'Fisherman's Cookbook' (Aust. Made)							\$ 10.00	\$
'How to become a better 'fisherman' book let (including bonus hook disgorger)							\$ 4.00	\$
*postage and handling per order (incl. GST)							\$ 8.00	
Prices apply within Australia only. Overseas customers please write/fax for quote							total	

Tick appropriate box: ☐ Bankcard ☐ Visa ☐ MasterCard

--	--	--	--

Name on card

Expiry Date / /

Name: _____

Address: _____

P/C:

merchandise

No stamp required
if posted in Australia



Delivery Address:
PO Box 105
GOODNA QLD 4300



Alvey Reels (Australia)
Reply Paid 105
GOODNA QLD 4300

reel profiles



reel profiles

spooling a reel

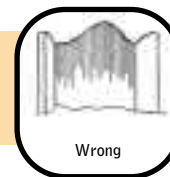

Fishing line is not included within the price of the reels. All specifications and information contained herein was correct at the time of print, variations may occur in the future. Alvey Reels (Australia) does not accept any responsibility for any loss or damage incurred by any person directly or indirectly due to the reliance on such information and the users of such information do so at their own risk.



ALVEY REELS (AUSTRALIA)
FOUNDED 1920
P.O. Box 105, Goodna
Queensland 4300, Australia
Tel: 07-3271 2844
Fax: 07-3271 2451
International:
Tel: 61 7-3271 2844
Fax: 61-7 3271 2451
Email: info@alvey.com.au

